

## Ramme til Indbyg (Recessed Mounting Bracket for Panel Light)

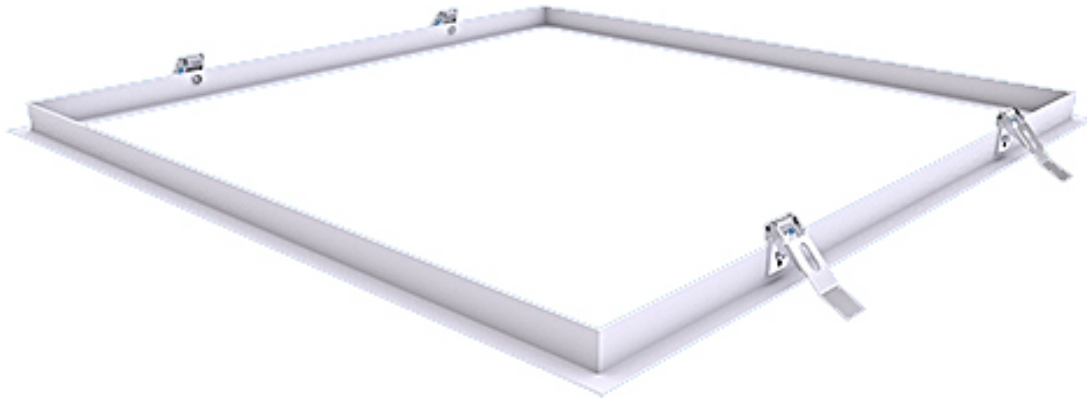

Material:

6063-T5 Aluminum alloy

Forming Process:

Gapless welding craft

Dimension:

23.7\*24.3\*1.6mm (W\*H\*Thickness)

Installation:

Recessed

Color:

Matte White

Load bearing:

10Kg

Package:

PE bag wrap or Inner box (2 choice) + Label  
+ Outer carton

Deformation degree:

within 1mm

RoHS Standard

Usage:

Used for recessed installation of panel light

# Ramme til Indbyg

(Recessed Mounting Bracket for Panel Light)

## • Drawing

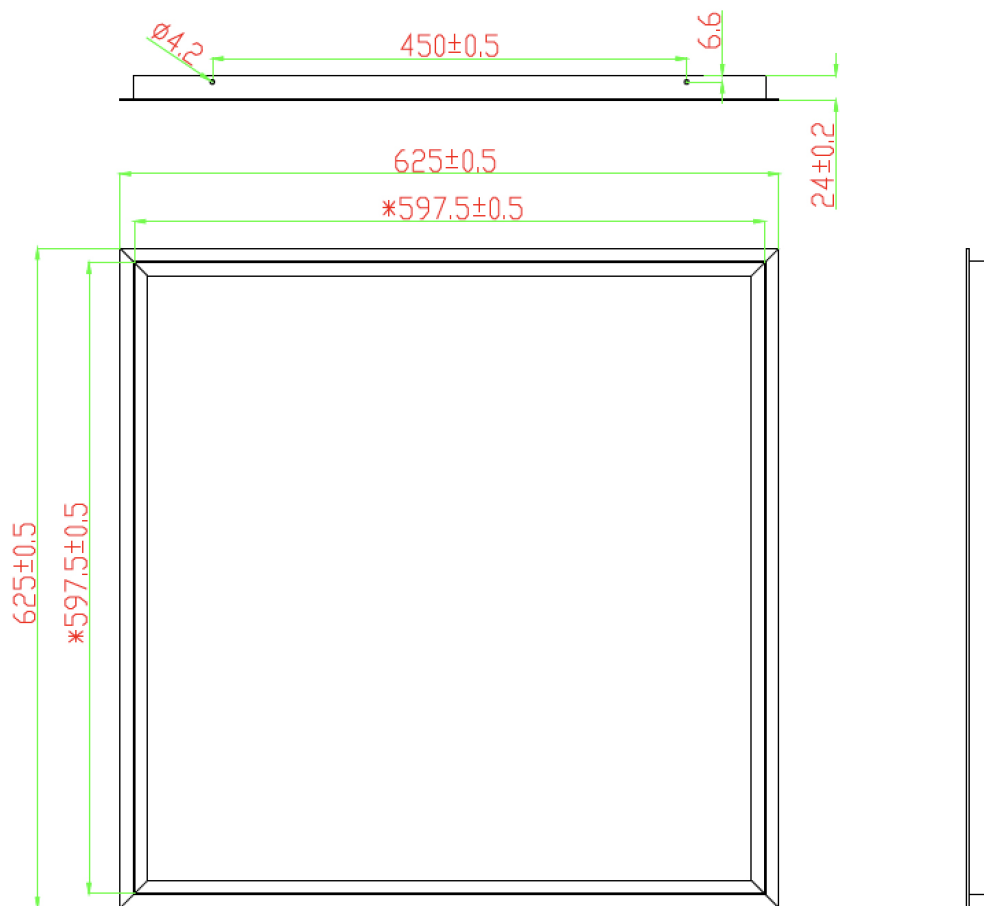
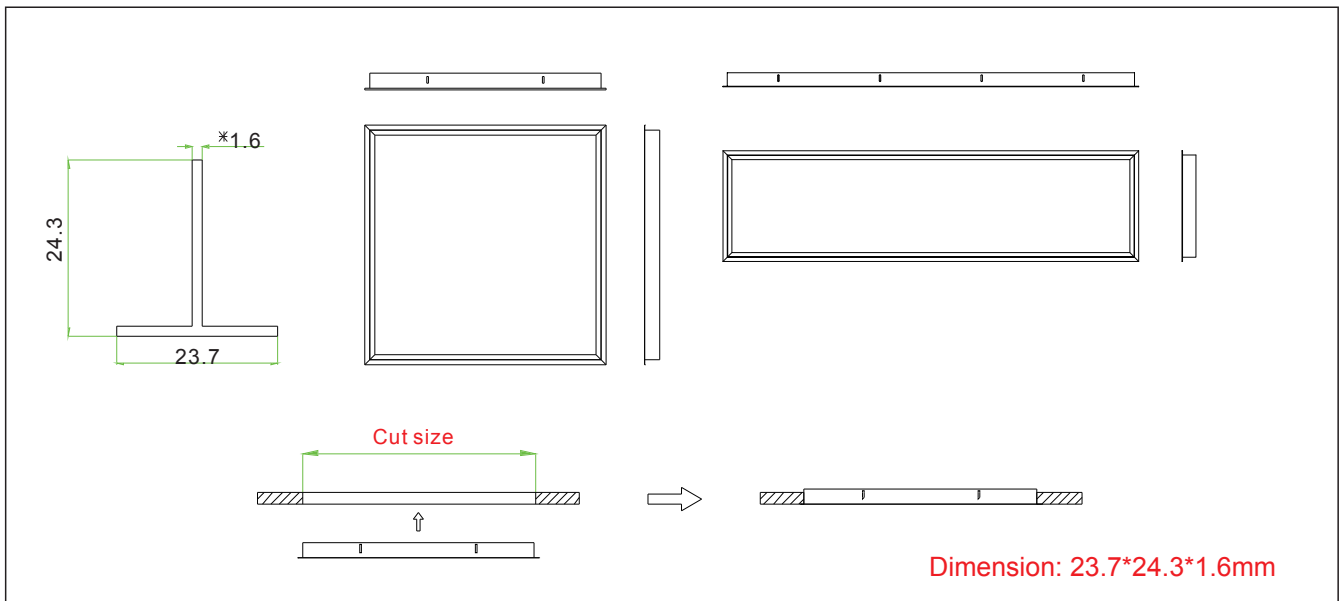

# Ramme til Indbyg (Recessed Mounting Bracket for Panel Light)

## • Installation Guide

1. Assembling the frame. Just fixing and adjust the spring clips with screws as per the steps as below from photo 1 to photo 2.

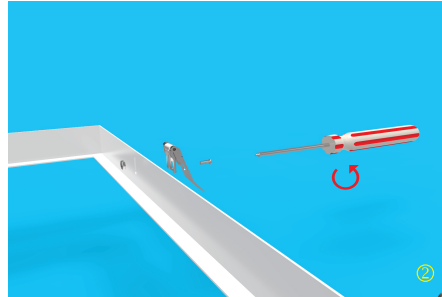
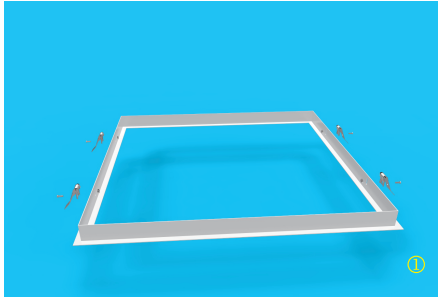

2. Installing the frames. Putting one side of the frames into ceiling hole and fixing it with spring clips, following the way to fix another side, ensuring the frames fixing wall and safe, putting the panel light fixture inside and place it on the recessed frames.

